

## SMT SERIES

- Automatic rebound function provides clamping force and achieves anti-loosening
- The spring can absorb tolerances of the upper and lower panels, providing a perfect operating feeling
- The angle design fulfills quick-release in different axial directions
- SMT fully automated manufacturing process can increase production stability and production efficiency

## SMT Angle Spring Lock Patented.



### Material and Finish

#### Cap :

300 Series Stainless Steel, Natural Finish.

#### Rivet :

300 Series Stainless Steel, Natural Finish.

#### Ferrule :

Carbon Steel, Tin Finish.

#### Spring :

300 Series Stainless Steel, Natural Finish.

### Reel

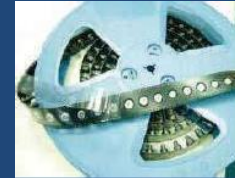

## Panel Preparation

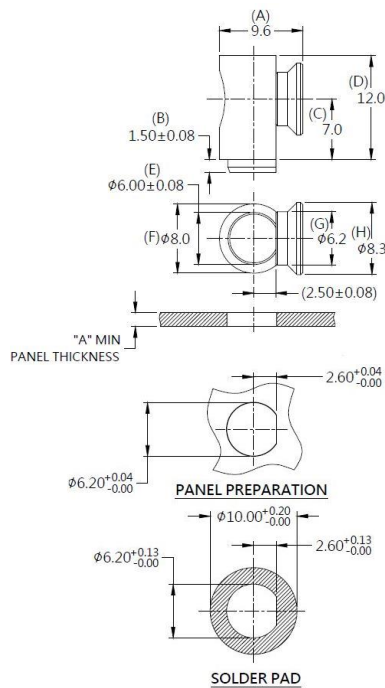

## Installation Style

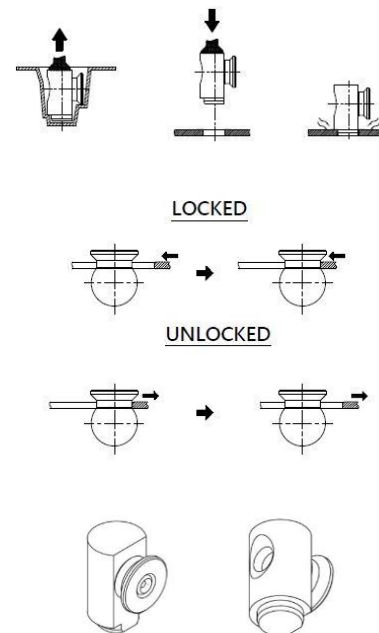

## Dimensions (mm)

LENGTH "T"	PROJECTION		PANEL THICKNESS		DIMENSINOS	
	"H-1"	"H-2"	"A" MIN	"A" MAX	" L "	" B "
			1.6	~		