

## RING PULL SERIES

- special ring knob design offers handle-pulling features and benefits
- ring knob adds operation convenience
- ring pull handle color and product specification can be customized

## RING PULL SERIES - Ring type Patented.



### Material and Finish

**Ring :**  
Plastic  
**Screw :**  
Carbon Steel, Zinc Finish  
**Material :**  
Carbon Steel, Nickel Finish

### Panel Preparation

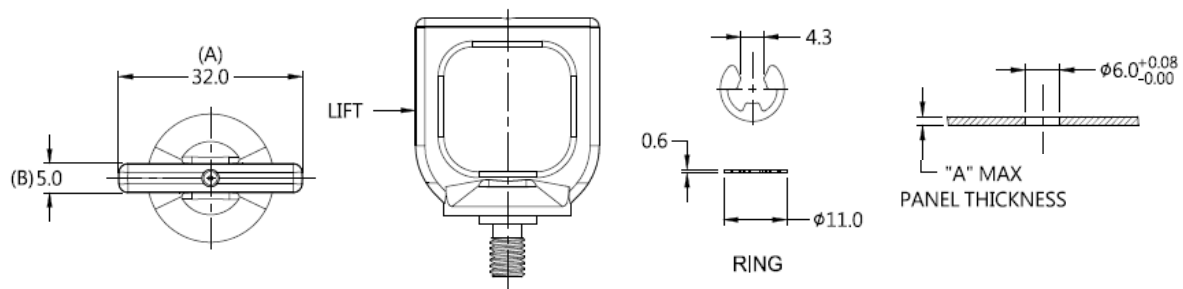

### Installation

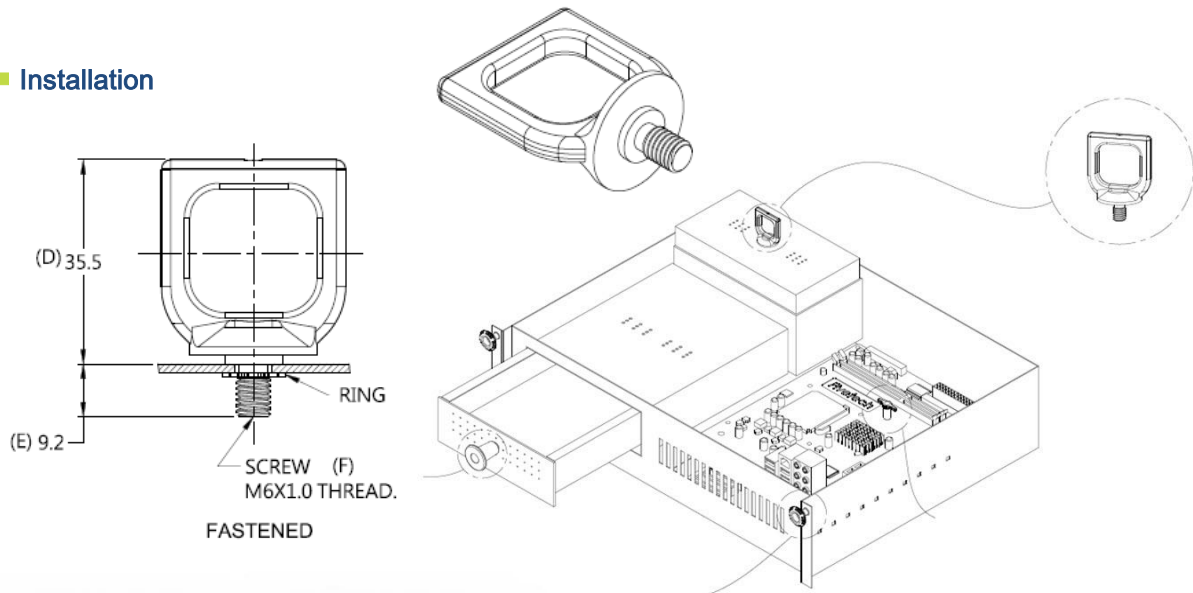

### Knob Color Options

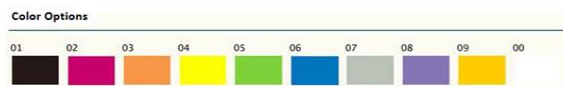

### Dimensions (mm)

SCREW LENGTH "T"	SCREW PROJECTION		PANEL THICKNESS		DIMENSINOS	
	"P-1"	"P-2"	"A" MIN	"A" MAX	"L"	"B"
			~	1.6		