

RING PULL SERIES

- special 22mm knob design offers handle-pulling features and benefits
- over-size knob 22mm adds operation convenience
- knob color and product specification can be customized

SMT Ring Pull -22mm Knob type patented.



Material and Finish

Knob :
Plastic
Screw :
Carbon Steel, Zinc Finish
Ferrule :
Carbon Steel, Nickel Finish



Panel Preparation

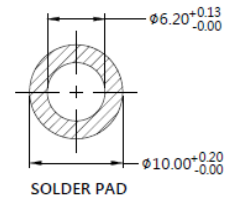
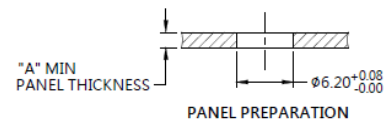
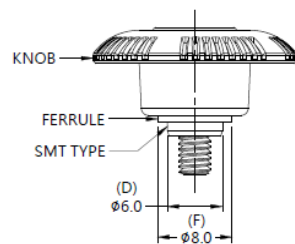
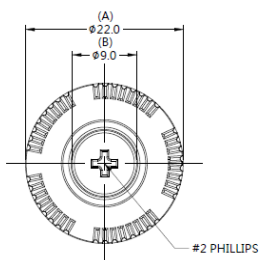

Installation

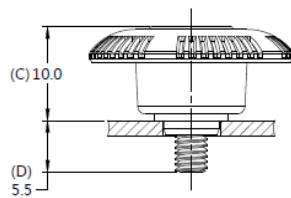

FASTENED

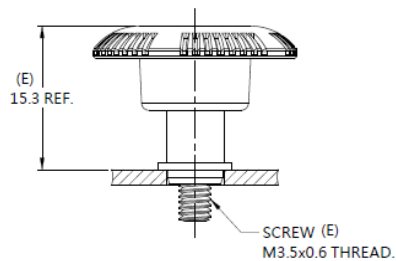

UNFASTENED

Knob Color Options

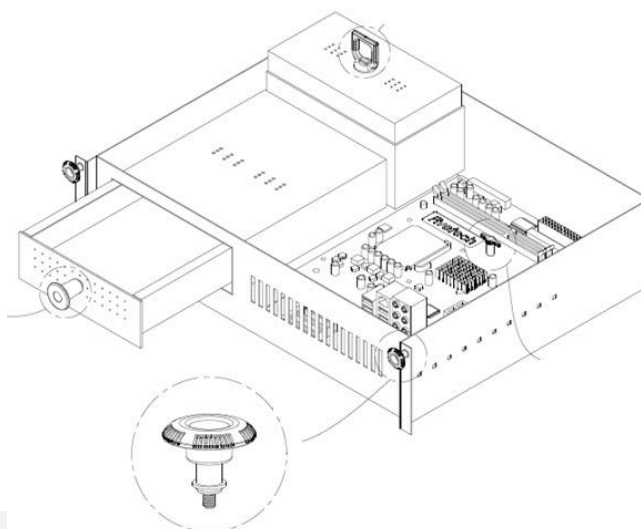

Dimensions (mm)

SCREW LENGTH "T"	SCREW PROJECTION		PANEL THICKNESS		DIMENSINOS	
	"P-1"	"P-2"	"A" MIN	"A" MAX	"L"	"B"
~	~	~	1.6	~		