

RETRACTIVE HANDLE

- Special retractive handle design for stronger spring force.
- Particular purposes for lifting very heavy bigger storage server chassis.
- Plastic handle reduces slip, heat, static electricity
- Plastic color management is available

71 SERIES



Material and Finish

BASE:
SPCC , CHROMIUM PLATING.
HANDLE:
CARBON STEEL , CHROMIUM PLATING; TPU , PANTONE BLACK.
SPRING:
SPRING : 300 SERIES STAINLESS STEEL , NATURAL FINISH.

Panel Preparation

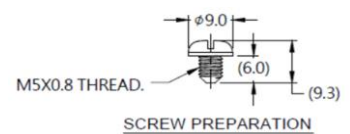
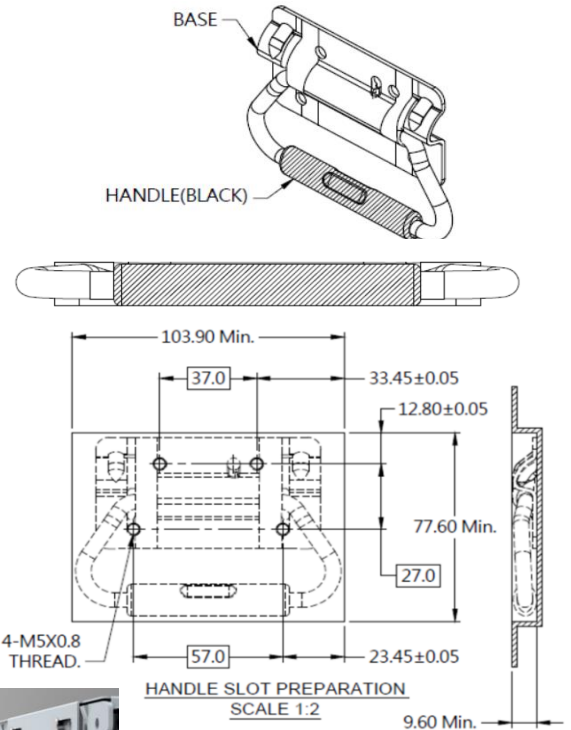
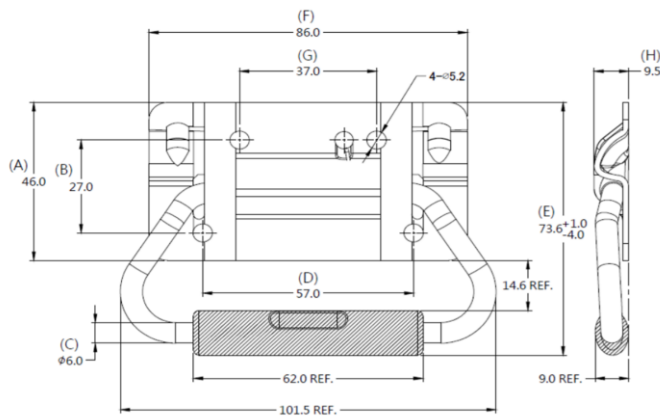

Knob Color Options



Dimensions (mm)

SCREW LENGTH "T"	SCREW PROJECTION		PANEL THICKNESS		DIMENSINOS	
	"P-1"	"P-2"	"A" MIN	"A" MAX	" L "	" B "
~	~	~	~	~	~	~

Copyright © Since 2007-2018 Fivetech Technology Inc. All Right Reserved.