

## Latch

- Multiple design, material and finish options available
- Multiple options available to meet customer application requirements.

## PADDLE LATCH



### Material and Finish

**Latching Spring :**  
 Carbon Steel, Black Powder Coat.  
**Lever :**  
 Carbon Steel, Zinc Finish.  
**Pin :**  
 300 Series Stainless Steel, Natural Finish.

### Projection

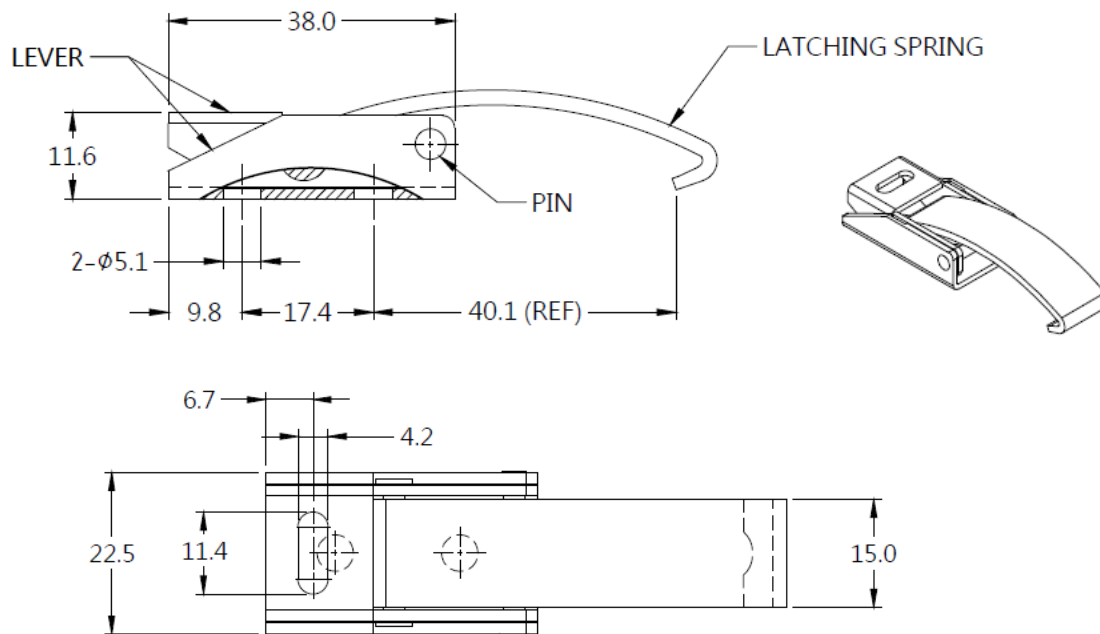

### ■ Dimensions(mm)