

## PLUNGER

- Efficient performance in assembly, decomposition, and repair
- Fast installation and removal for sliding module.
- Color management for plastic is available as required by customers.

## NON-POSITIONING PLUNGER $\phi 15\text{mm}$ Patented.



### Material and Finish

**Knob :**  
Carbon Steel, Zinc Finish, Plastic

**Pin :**  
Carbon Steel, Zinc Finish.

**Spring :**  
300 Series Stainless Steel, Natural Finish.

**Ferrule :**  
6000 Series Aluminum, Natural Finish.

### ■ Projection

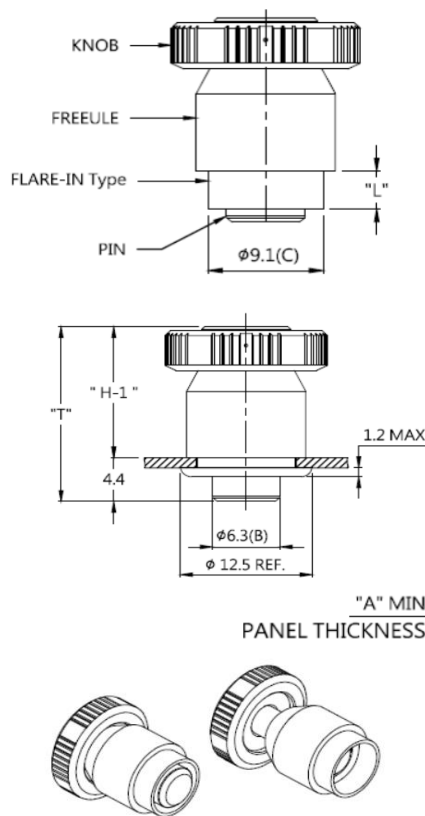

### ■ Installation Style

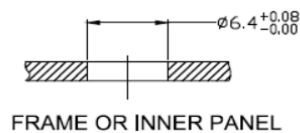
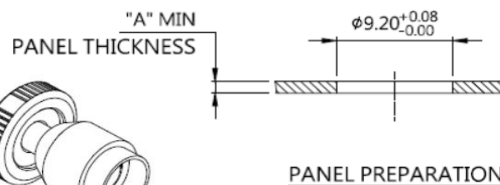
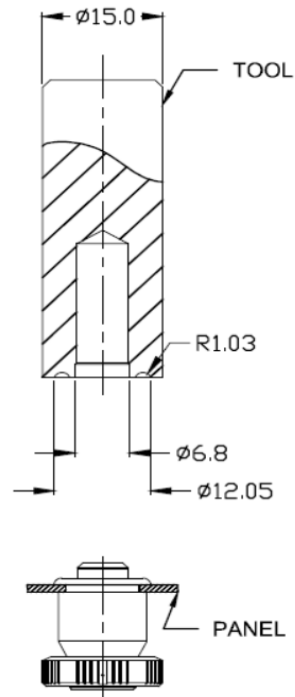

### ■ Knob Color Options



### ■ Dimensions(mm)

PANEL THICKNESS		T	H-1	H-2	P-1
A MIN	A MAX				
1.0	-	17.6	13.2	17.2	4.4