

- Color management for plastic material is available as required by customers
- Plastic knob can isolate ambient heat source and static

27 SERIES



Material and Finish

- Knob:**
6000 Series aluminum, plastic "pp".
- Screw:**
400 Series stainless steel, passivated.
- Spring:**
300 Series stainless steel, natural.
- Ferrule:**
Press-in: Hardened carbon steel, zinc finish.
P.C.Board: 300 Series stainless steel, natural.

■ Recess Style



■ Knob Height and Screw Projection (Press-in Style Shown)

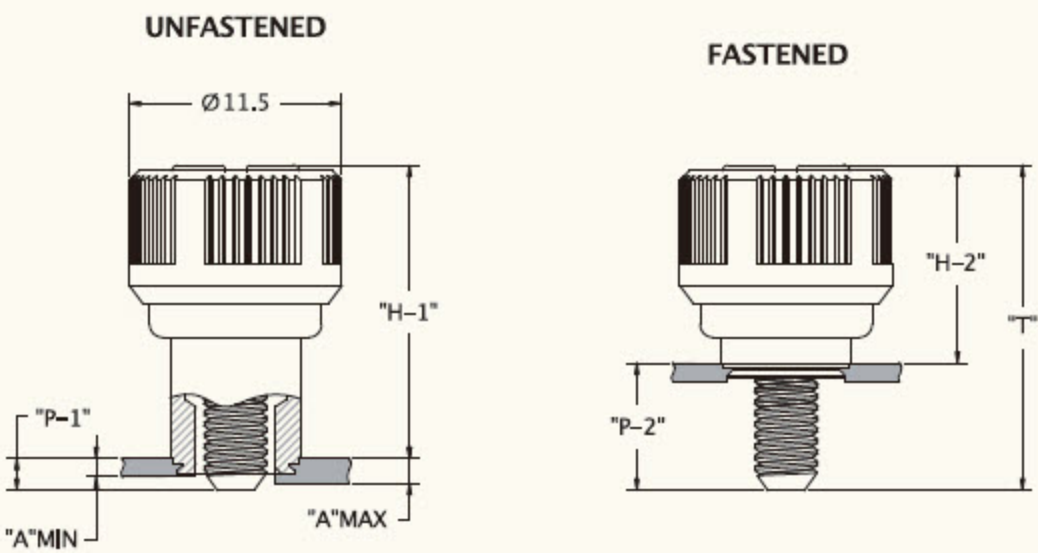

■ Installation Style

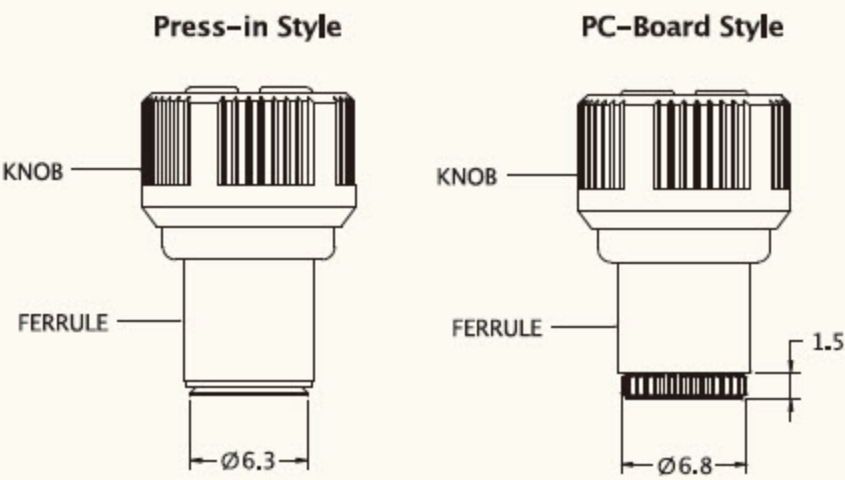

■ Knob Color Options

| Standard colors | | | | | | | |
|-----------------|----|----|----|----|----|----|----|
| 01 | 02 | 03 | 04 | 05 | 06 | 07 | 08 |
| | | | | | | | |

■ 6-32 Thread Size

27-412-440-() ← 01~08 (color number.)

| INSTALLATION STYLE | OUTER PANEL DIMENSIONS | | | KNOB HEIGHT | | SCREW PROJECTION | | TOTAL FLOAT | PART NUMBER | | | | |
|--------------------|------------------------|-------|---|-------------|------|------------------|-----|-------------|----------------|-----------------|----------------|----------------|----------------------|
| | A MIN | A MAX | B | H-1 | H-2 | P-1 | P-2 | | Slot Recess | Phillips Recess | 6L Recess | 6L/Slot Recess | Phillips/Slot Recess |
| Press-in Style | 0.8 | ~ | ~ | 15.9 | 10.7 | 0.6 | 5.8 | 0.5 | 27-412-140-() | 27-412-240-() | 27-412-340-() | 27-412-440-() | 27-412-540-() |
| | 0.8 | ~ | ~ | 15.9 | 10.7 | 2.1 | 7.3 | | 27-412-150-() | 27-412-250-() | 27-412-350-() | 27-412-450-() | 27-412-550-() |
| PC-Board Style | 1.6 | ~ | ~ | 15.2 | 10.0 | 1.3 | 6.5 | | 27-440-140-() | 27-440-240-() | 27-440-340-() | 27-440-440-() | 27-440-540-() |
| | 1.6 | ~ | ~ | 15.2 | 10.0 | 2.8 | 8.0 | | 27-440-150-() | 27-440-250-() | 27-440-350-() | 27-440-450-() | 27-440-550-() |

Installation for all styles
For panel preparation and installation instructions, see page 34 and 35.

CAPTIVE SCREW

- Fast positioning device no require extra tools.
- Color management for plastic material is available
- Plastic knob can isolate ambient heat source and static.

27 SERIES CAPTIVE SCREW Ø9.5mm Patented.



Material and Finish

Knob :
6000 Series Aluminum, Plastic.

Screw :
400 Series Stainless Steel, Natural Finish.

Spring :
300 Series Stainless Steel, Natural Finish.

Ferrule :
Hardened Carbon Steel, Zinc Finish.

Recess Style



Knob High and Screw Projection

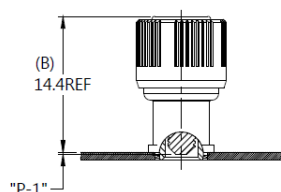

UNFASTENED

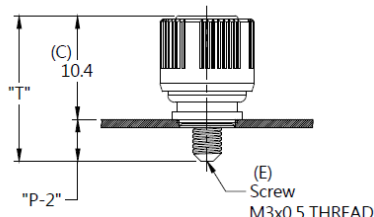

FASTENED

Installation Style

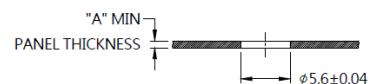
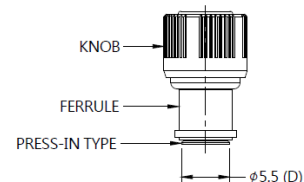

Knob Color Options



PANEL PREPARATION

Dimensions(mm)

| INSTALLATION STYLE | THREAD | OUTER PANEL DIMENSIONS | | SCREW PROJECTION | | | KNOB HEIGHT | |
|--------------------|--------|------------------------|-------|------------------|-----|-----|-------------|------|
| | | A MIN | A MAX | T | P-1 | P-2 | H-1 | H-2 |
| Press-in Style | M3 | 0.8 | - | 14.6 | 0.2 | 4.2 | 14.4 | 10.4 |

CAPTIVE SCREW

- Fast positioning device is a fast solution that does not require extra tools.
- Designed for hand operation.
- Spring-ejected.
- The size of device and assembly method could be customized.

27 SERIES Captive Screw Ø10mm



Material and Finish

Knob :
6000 Series Aluminum, Plastic
Screw :
400 Series Stainless Steel, Natural Finish.
Spring :
300 Series Stainless Steel, Natural Finish.
Ferrule :
Press-in : Hardened Carbon Steel, Zinc Finish.
Flare-in : 6000 Series Aluminum, Natural Finish.

Recess Style



Installation Style

Knob High and Screw Projection (Press-in Style Shown)

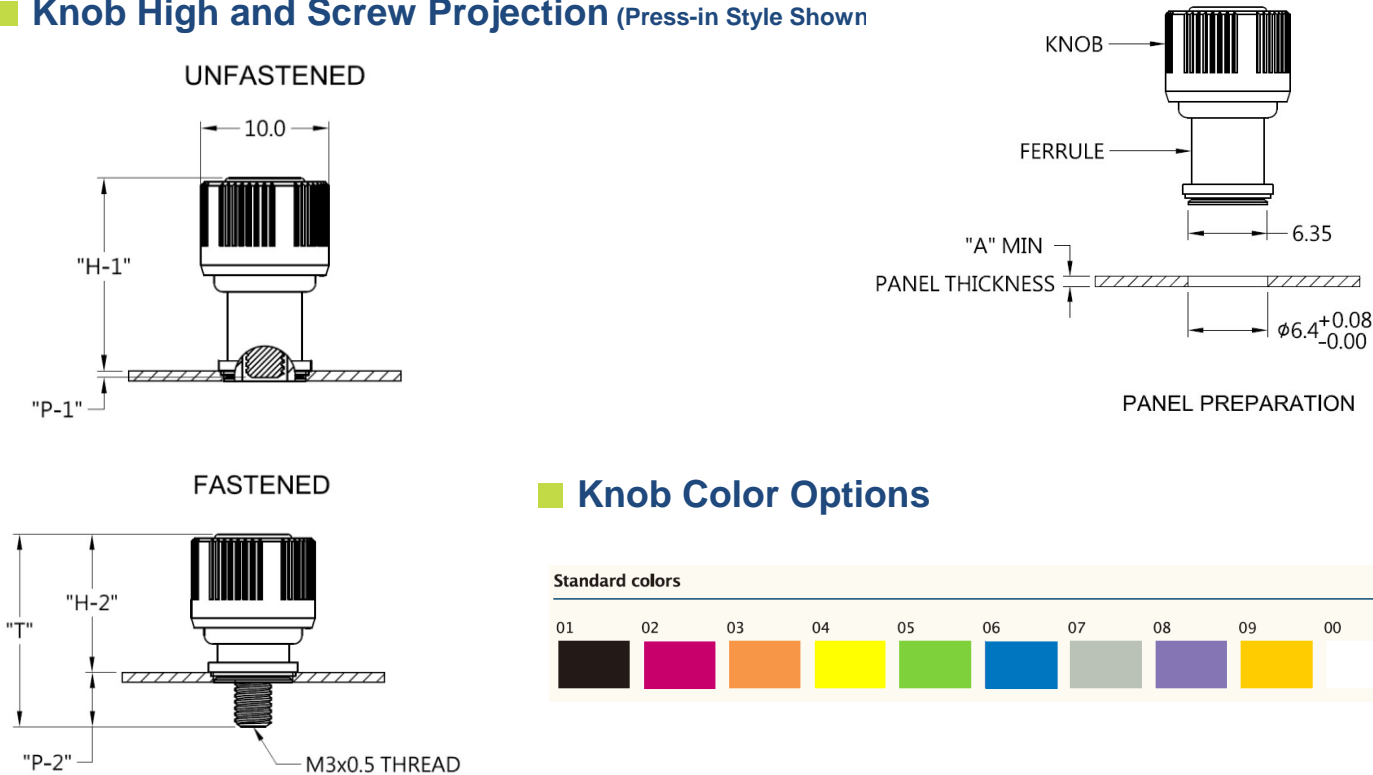

Dimensions

| INSTALLATION STYLE | THREAD | OUTER PANEL DIMENSIONS | | SCREW PROJECTION | | | KNOB HEIGHT | |
|-----------------------|--------|---------------------------|-------|---------------------|-----|-----|----------------|------|
| | | A MIN | A MAX | T | P-1 | P-2 | H-1 | H-2 |
| Press-in Style | M3 | 0.8 | - | 15.6 | 0.5 | 4.4 | 15.1 | 11.2 |
| Flare-in Style | M3 | 1.0 | - | 15.6 | 0.6 | 4.2 | 15.2 | 11.4 |

CAPTIVE SCREW

- Fast positioning device, no require extra tool.
- Designed for hand operation.
- Spring-ejected.
- Color management is available as required by customers.
- The size of device and assembly method could be customized.

27 SERIES Captive Screw Ø10mm-Smooth Knob Patented



Material and Finish

Knob :
8000 Series Aluminum, Plastic

Screw :
400 Series Stainless Steel, Natural Finish.

Spring :
300 Series Stainless Steel, Natural Finish.

Ferrule :
Press-in : Hardened Carbon Steel, Zinc Finish.
Flare-in : 6000 Series Aluminum, Natural Finish.

Recess Style



Knob High and Screw Projection (Press-in Style Shown)

Installation Style

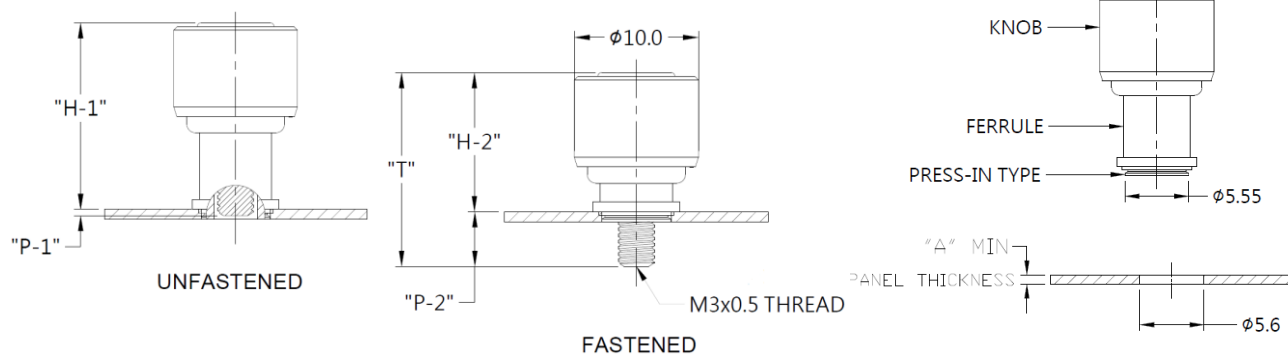

Knob Color Options



PANEL PREPARATION

Dimensions(mm)

| INSTALLATION STYLE | THREAD | OUTER PANEL DIMENSIONS | | SCREW PROJECTION | | | KNOB HEIGHT | |
|--------------------|--------|------------------------|-------|------------------|-----|-----|-------------|------|
| | | A MIN | A MAX | T | P-1 | P-2 | H-1 | H-2 |
| Press-in Style | M3 | 0.8 | - | 15.6 | 0.5 | 4.4 | 15.1 | 11.2 |
| Flare-in Style | M3 | 1.0 | - | 15.6 | 0.6 | 4.2 | 15.2 | 11.4 |

CAPTIVE SCREW

Designed for hand operation

Fast positioning device that does not require extra tools

Color management for plastic material is available

Plastic knob can isolate ambient heat source and static

Captive Screw- Square Type Patented.



Material and Finish

Knob :

6000 Series Aluminum, Plastic

Screw:

400 Series Stainless Steel, Natural Finish

Spring :

300 Series Stainless Steel, Natural Finish

Ferrule :

400 Series Stainless Steel, Natural Finish

Installation

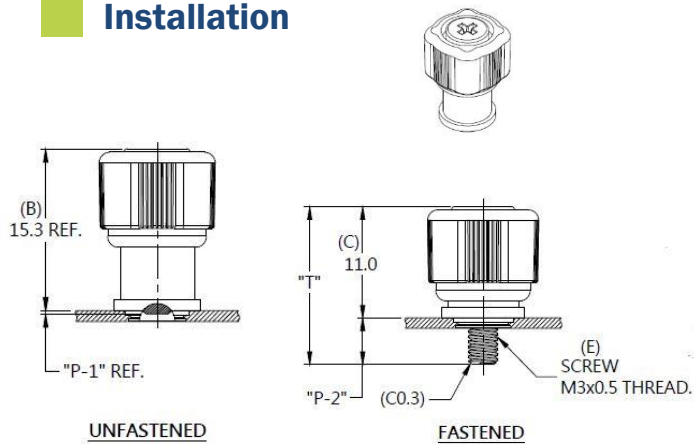

Panel Preparation

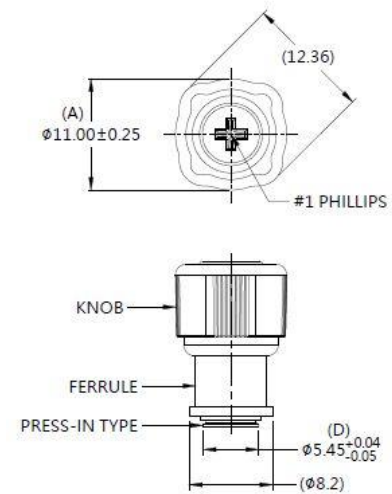

Color Options

Color Options

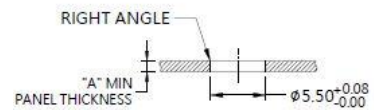

Dimensions (mm)

| SCREW LENGTH "T" | SCREW PROJECTION | | PANEL THICKNESS | | DIMENSINOS | |
|------------------------|------------------|-------|-----------------|---------|------------|-------|
| | "P-1" | "P-2" | "A" MIN | "A" MAX | " L " | " B " |
| 15.6 | 0.3 | 4.6 | 1.0 | ~ | | |

CAPTIVE SCREW

Designed for hand operation

Fast positioning device that does not require extra tools

Color management for plastic material is available

Plastic knob can isolate ambient heat source and static

Captive Screw- Cloud Type Patented.



Material and Finish

Knob:

6000 Series Aluminum, Plastic

Screw :

Carbon Steel, Zinc Finish

Spring :

300 Series Stainless Steel, Natural Finish

Ferrule :

Carbon Steel, Zinc Finish

Installation

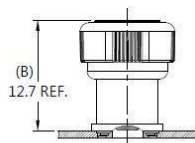

UNFASTENED

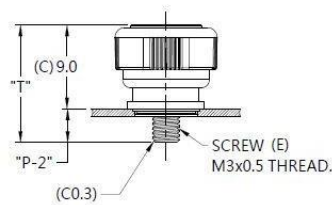

FASTENED

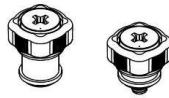

Color Options

Color Options



Panel Preparation

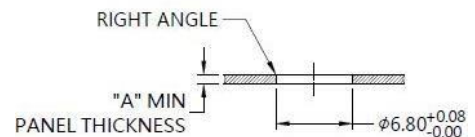
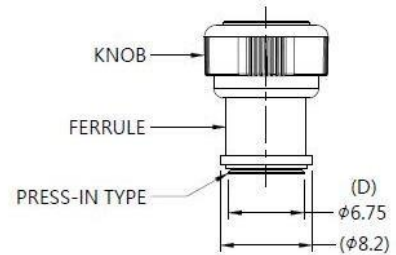
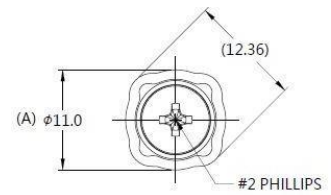

Dimensions (mm)

| SCREW LENGTH "T" | SCREW PROJECTION | | PANEL THICKNESS | | DIMENSINOS | |
|---------------------|------------------|-------|-----------------|---------|------------|-------|
| | "P-1" | "P-2" | "A" MIN | "A" MAX | " L " | " B " |
| 12.6 | ~ | 3.6 | 0.8 | ~ | | |

CAPTIVE SCREW

Designed for hand operation

Fast positioning device that does not require extra tools

Color management for plastic material is available

Plastic knob can isolate ambient heat source and static

Captive Screw- Square Type Patented.



Material and Finish

Knob:

6000 Series Aluminum, Plastic

Screw :

Carbon Steel, Zinc Finish

Spring :

300 Series Stainless Steel, Natural Finish

Ferrule :

Carbon Steel, Zinc Finish

Installation

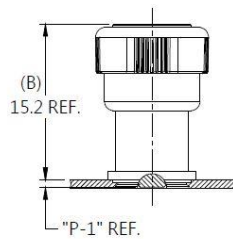

UNFASTENED

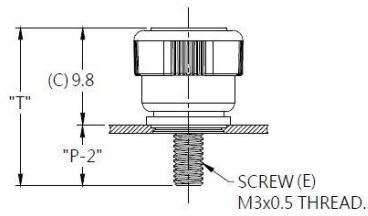

FASTENED



Color Options

Color Options



Panel Preparation

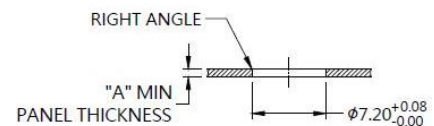
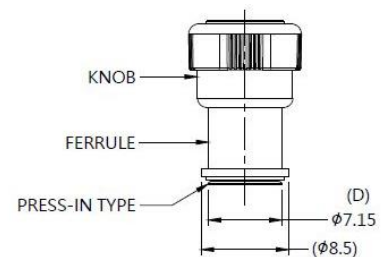
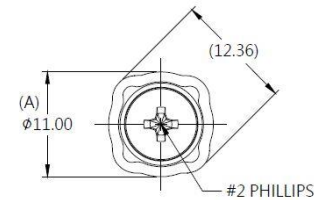

Dimensions (mm)

| SCREW LENGTH "T" | SCREW PROJECTION | | PANEL THICKNESS | | DIMENSINOS | |
|---------------------|------------------|-------|-----------------|---------|------------|-------|
| | "P-1" | "P-2" | "A" MIN | "A" MAX | " L " | " B " |
| 15.9 | 0.7 | 6.1 | 0.8 | ~ | | |

CAPTIVE SCREW

- Fast positioning device is a fast solution that does not require extra tools.
- Designed for hand operation.
- Spring-ejected.
- The size of device and assembly method could be customized.

27 SERIES Captive Screw Ø13mm



Material and Finish

Knob :
6000 Series Aluminum, Plastic

Screw :
Hardened Carbon Steel, Zinc Finish.

Spring :
300 Series Stainless Steel, Natural Finish.

Ferrule :
6000 Series Aluminum, Natural Finish.

Washer :
300 Series Stainless Steel, Natural Finish.

Recess Style



Installation Style

Knob High and Screw Projection

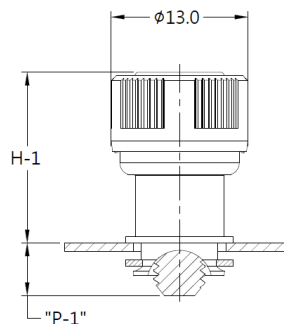

UNFASTENED

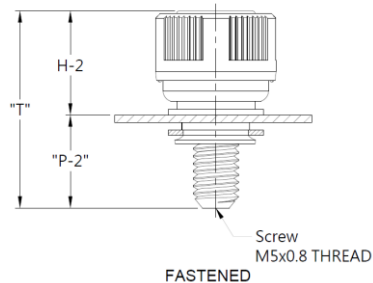

FASTENED

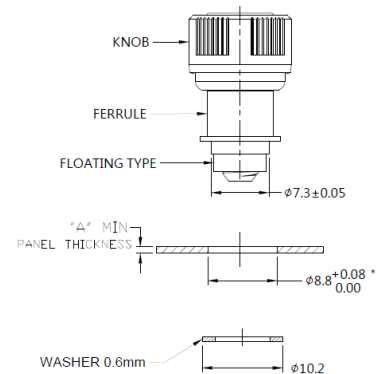

PANEL PREPARATION

Knob Color Options

Standard colors



Dimensions

| INSTALLATION STYLE | THREAD | OUTER PANEL DIMENSIONS | | SCREW PROJECTION | | | KNOB HEIGHT | |
|--------------------|--------|------------------------|-------|------------------|-----|-----|-------------|------|
| | | A MIN | A MAX | T | P-1 | P-2 | H-1 | H-2 |
| Floating Style | M5 | 0.8 | - | 21.2 | 5.0 | 10 | 16.2 | 11.2 |

CAPTIVE SCREW

- High Profile design for hand operation
- Spring-ejected
- Color management for plastic material is available
- Plastic knob can isolate ambient heat source and static

27 SERIES CAPTIVE SCREW Ø13.35mm High Profile Patented.



Material and Finish

KNOB:
6000 SERIES ALUMINUM , PLASTIC : PANTONE 376C(GREEN).

SCREW:
400 SERIES STAINLESS STEEL , NATUAL FINISH.

SPRING:
300 SERIES STAINLESS STEEL , NATUAL FINISH.

FERRULE:
6000 SERIES ALUMINUM, NATUAL FINISH.

WASHER:
300 SERIES STAINLESS STEEL , NATUAL FINISH.

Panel Preparation

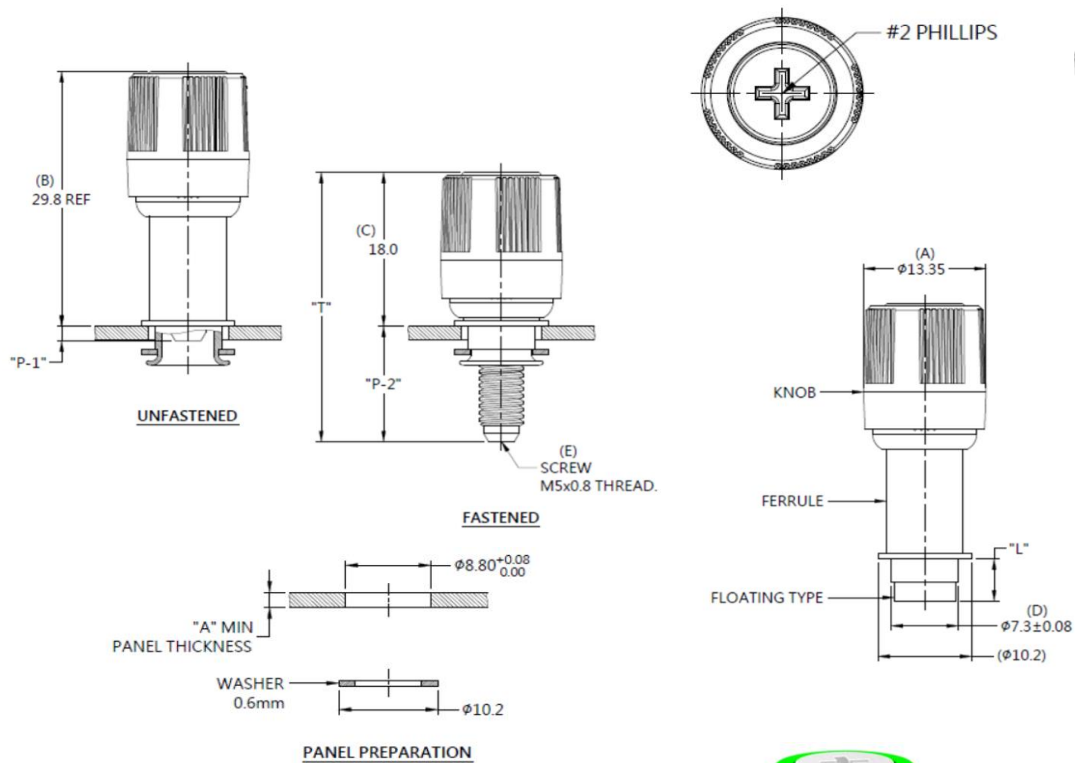

Knob Color Options



Dimensions (mm)

| SCREW LENGTH "T" | SCREW PROJECTION | | PANEL THICKNESS | | DIMENSINOS | |
|---------------------|------------------|-------|-----------------|---------|------------|-------|
| | "P-1" | "P-2" | "A" MIN | "A" MAX | " L " | " B " |
| 31.5 | 1.7 | 13.5 | 1.6 | 2.5 | 4.9 | ~ |

Copyright © Since 2007-2018 Fivetech Technology Inc. All Right Reserved.

CAPTIVE SCREW

- ## 27 SERIES CAPTIVE SCREW Ø14.7mm High Profile Patented.

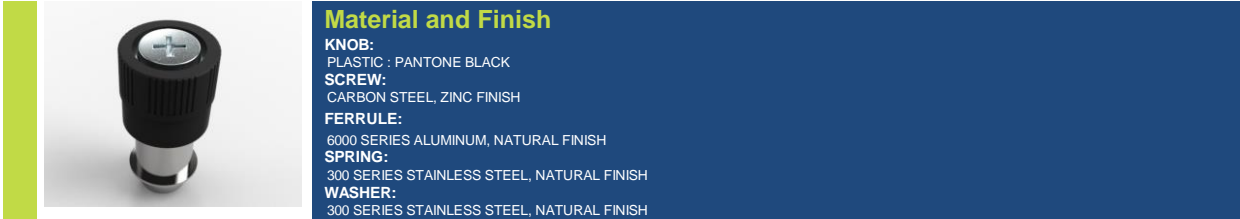

KNOB:
PLASTIC : PANTONE BLACK
SCREW:
CARBON STEEL, ZINC FINISH
FERRULE:
6000 SERIES ALUMINUM, NATURAL FINISH
SPRING:
300 SERIES STAINLESS STEEL, NATURAL FINISH
WASHER:
300 SERIES STAINLESS STEEL, NATURAL FINISH

Panel Preparation

(A) $\phi 14.6$
#2 PHILLIPS

KNOB
FERRULE
FLOATING TYPE
"L"
(D) $\phi 8.90 \pm 0.08$
($\phi 12.0$)
"A" MIN PANEL THICKNESS
 $\phi 10.00^{+0.08}_{0.00}$

(C) 17.3
"P-2"
FASTENED
SCREW (E) M6x1.0 THREAD.

(B) 27.6 REF.
"P-1"

UNFASTENED

PUNCH
WASHER
PANEL
CAPTIVE SCREW
SMOOTH SURFACE
ANVIL
SCALE: 1:1

Knob Color Options

Color Options: 01 02 03 04 05 06 07 08 09 10

01 02 03 04 05 06 07 08 09 10

Three views of a screw. The left view shows the top of the screw with a black, ribbed cap and a silver-colored base. The middle view shows the side of the screw, highlighting the black cap and the silver-colored shaft. The right view shows the bottom of the screw, revealing the threaded portion of the shaft.

| SCREW LENGTH "T" | SCREW PROJECTION | | PANEL THICKNESS | | DIMENSINOS | |
|------------------------|------------------|-------|-----------------|---------|------------|-------|
| | "P-1" | "P-2" | "A" MIN | "A" MAX | " L " | " B " |
| 31.0 | 3.4 | 13.7 | 1.6 | 2.4 | 4.8 | |

CAPTIVE SCREW

- Designed for hand operation.
- Fast positioning device that does not require extra tools.
- Color management for plastic material is available.
- Plastic knob can isolate ambient heat source and static.

27 SERIES Captive Screw Ø18mm - Flare-in Patented.



Material and Finish

Knob :
6000 Series Aluminum, Plastic.

Screw :
Carbon Steel, Zinc Finish.

Spring :
300 Series Stainless Steel, Natural Finish.

Ferrule :
6000 Series Aluminum, Natural Finish.

Recess Style



Knob High and Screw Projection

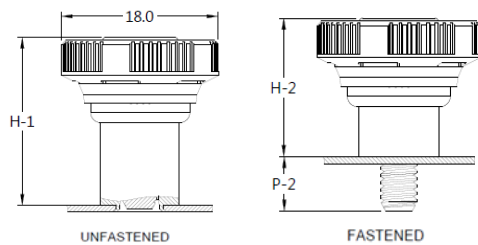

Installation Style

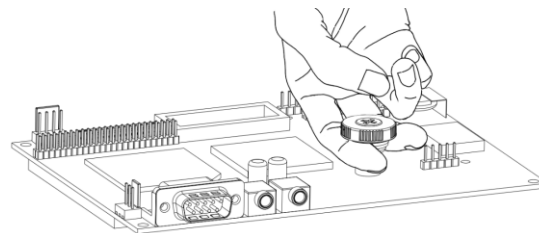
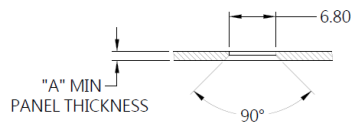
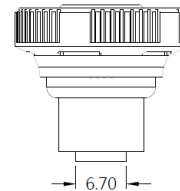

Knob Color Options



Dimensions(mm)

| INSTALLATION STYLE | THREAD | OUTER PANEL DIMENSIONS | | SCREW PROJECTION | | | KNOB HEIGHT | |
|-----------------------|--------|---------------------------|-------|---------------------|-----|------|----------------|-------|
| | | A MIN | A MAX | T | P-1 | P-2 | H-1 | H-2 |
| Flare-in Style | M5 | 1.0 | - | 21.2 | 1.3 | 6.05 | 19.9 | 15.15 |
| Flare-in Style | #10-32 | 1.0 | - | 21.2 | 1.3 | 6.05 | 19.9 | 15.15 |

CAPTIVE SCREW

- Designed for hand operation.
- Fast positioning device that does not require extra tools.
- Color management for plastic material is available.
- Plastic knob can isolate ambient heat source and static.

27 SERIES Captive Screw Ø18mm - Floating Patented.



Material and Finish

Knob :
6000 Series Aluminum, Plastic.

Screw :
Carbon Steel, Zinc Finish.

Spring :
300 Series Stainless Steel, Natural Finish.

Ferrule :
6000 Series Aluminum, Natural Finish.

Recess Style



Knob High and Screw Projection

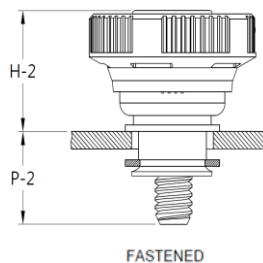
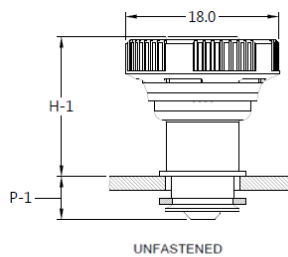

Installation Style

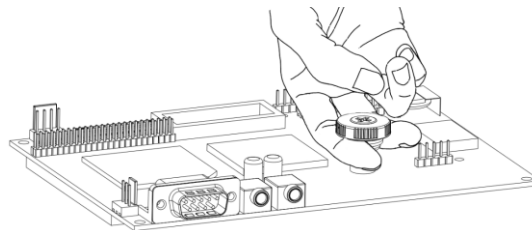
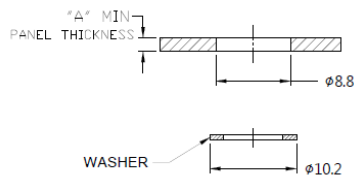
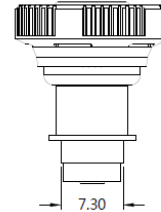

Knob Color Options



Dimensions(mm)

| INSTALLATION STYLE | THREAD | OUTER PANEL DIMENSIONS | | SCREW PROJECTION | | | KNOB HEIGHT | |
|-----------------------|--------|---------------------------|-------|---------------------|-----|-----|----------------|------|
| | | A MIN | A MAX | T | P-1 | P-2 | H-1 | H-2 |
| Floating Style | M5 | 1.0 | - | 21.2 | 5 | 10 | 16.2 | 11.2 |
| Floating Style | #10-32 | 1.0 | - | 21.2 | 5 | 10 | 16.2 | 11.2 |

CAPTIVE SCREW

- Designed for hand operation.
- Fast positioning device that does not require extra tools.
- Color management for plastic material is available.
- Plastic knob can isolate ambient heat source and static.

27 SERIES Captive Screw Ø18mm - Press-in Patented.



Material and Finish

Knob :
6000 Series Aluminum, Plastic.

Screw :
Carbon Steel, Zinc Finish.

Spring :
300 Series Stainless Steel, Natural Finish.

Ferrule :
Carbon Steel, Zinc Finish.

Recess Style



Knob High and Screw Projection

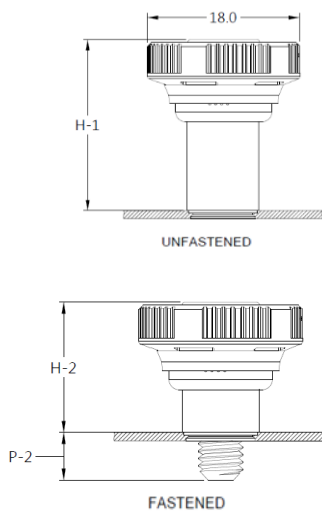

Installation Style

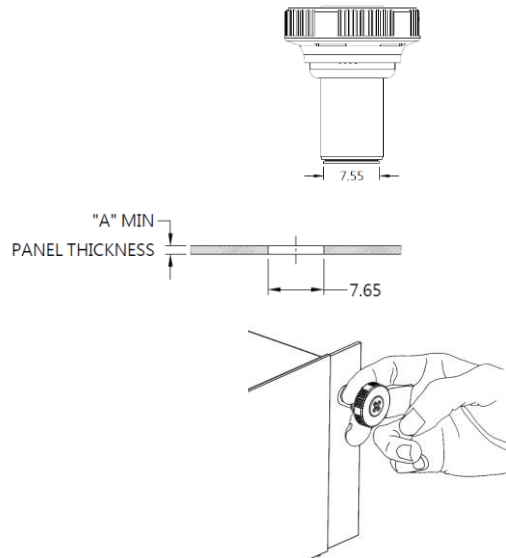

Knob Color Options

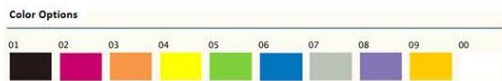

Dimensions(mm)

| INSTALLATION STYLE | THREAD | OUTER PANEL DIMENSIONS | | SCREW PROJECTION | | | KNOB HEIGHT | |
|-----------------------|--------|---------------------------|-------|---------------------|-----|-----|----------------|------|
| | | A MIN | A MAX | T | P-1 | P-2 | H-1 | H-2 |
| Press-in Style | M5 | 1.0 | - | 21.2 | 0.7 | 5.4 | 20.5 | 15.8 |
| Press-in Style | #10-32 | 1.0 | - | 21.2 | 0.7 | 5.4 | 20.5 | 15.8 |

SMT CAPTIVE SCREW

- Designed for hand operation.
- Fast positioning device that does not require extra tools.
- Color management for plastic material is available.
- Plastic knob can isolate ambient heat source and static.

29 SERIES SMT Captive Screw Ø18mm Patented.



Material and Finish

Knob :
6000 Series Aluminum, Plastic.

Screw :
Carbon Steel, Zinc Finish.

Spring :
300 Series Stainless Steel, Natural Finish.

Ferrule :
Carbon Steel, Tin Finish.

REEL



■ Recess Style



■ Knob High and Screw Projection

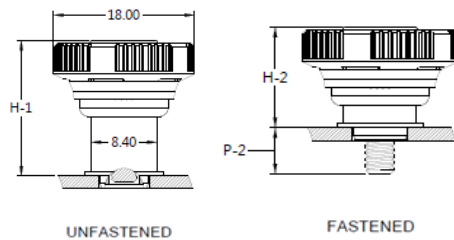

■ Installation Style

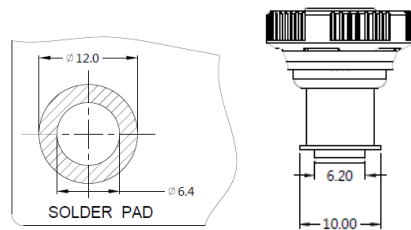

■ Installation

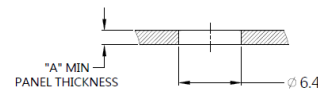
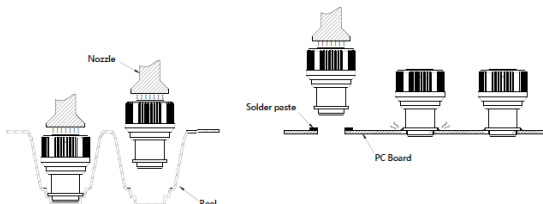

PANEL PREPARATION

■ Knob Color Options



■ Dimensions(mm)

| THREAD | OUTER PANEL DIMENSIONS | | SCREW PROJECTION | | | KNOB HEIGHT | |
|--------|------------------------|-------|------------------|-----|-----|-------------|------|
| | A MIN | A MAX | T | P-1 | P-2 | H-1 | H-2 |
| M3.5 | 1.6 | - | 16.5 | 0 | 4.1 | 17.3 | 12.4 |
| #6-32 | 1.6 | - | 16.5 | 0 | 4.1 | 17.3 | 12.4 |
| M3 | 1.6 | - | 16.5 | 0 | 4.1 | 17.3 | 12.4 |