

## PANEL LATCH

## Panel Latch



- Provides an opening solution for AI server cover.
- The safety lock secures the panel latch, preventing accidental cover loosening.
- Engineered with a spring mechanism for automatic rebound after unlocking, which is intuitive and user-friendly.
- The finger hole design of latch handle provides quick to grip and open operation function.
- Panel Latch applicate all types of server appliances.
- Modular design with high-tech appearance, stable and durable.
- Customizable with exclusive plastic colors tailored to the corporate identity.

Patented.

### Material and Finish

HOUSING : CARBON STEEL  
PIECE : CARBON STEEL  
PIN : ALUMINUM  
SPRING : STAINLESS STEEL  
HANDLE : PLASTIC  
RIVET : STAINLESS STEEL

### Panel Preparation

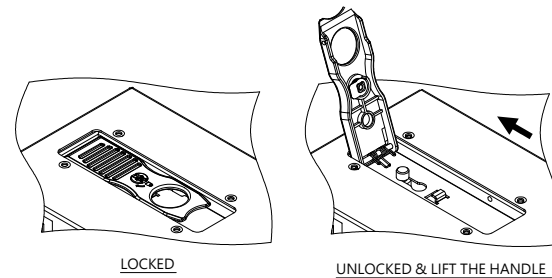
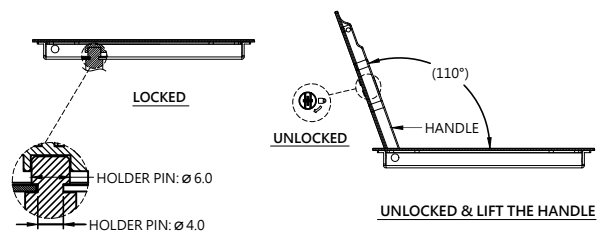
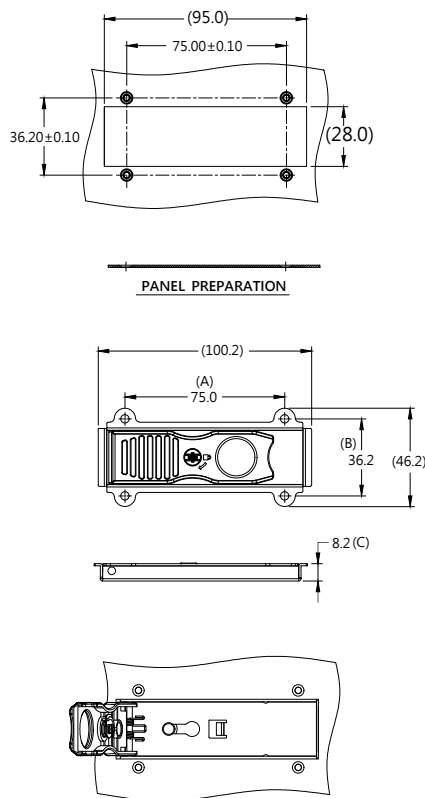

### Color Options



### Dimensions (mm)

LENGTH "T"	PROJECTION		PANEL THICKNESS		DIMENSIONS	
	"P-1"	"P-2"	"A" MIN	"A" MAX	" L "	" B "